



SIMPLICITY.
APPLIED.

M2M Access Control

Installation manual

Doc. nr. 06044, date: Jan-2025

Wiring the M2M Access Control

⚠ Wiring must only be done with the system switched off and the power source disconnected!

- Connect your RFID reader to the M2M Access Control:
 - Connect your RFID reader to the **AUX+** and **AUX-** ports of the M2M Access Control device, accordingly
 - Connect your RFID reader to the **Wiegand LD, IO, DO, D1** communication wires of the M2M Access Control, as shown below. Follow your RFID Reader installation instructions for wiring details.
- Connect the M2M Access Control **PWR+** and **PWR-** ports to a 12V DC power supply.

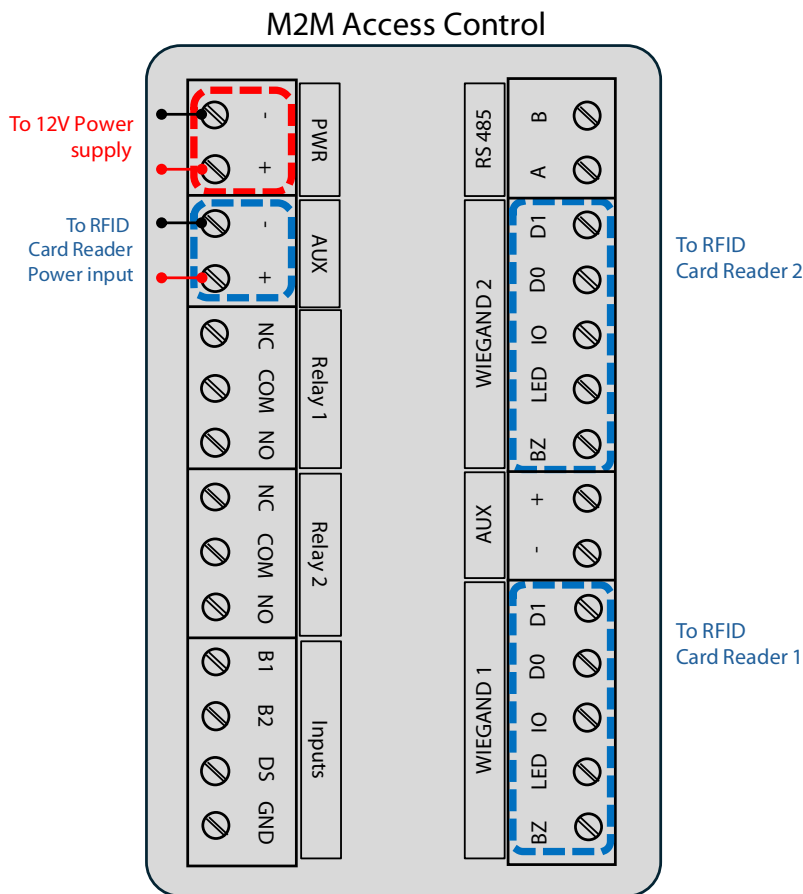

Port meanings

Ports	Function
B1 and B2 inputs	Used to connect buttons (for doorbell and door open)
DS	Door sensor input
BZ	Used to trigger the RFID reader internal buzzer
Relay 1 and Relay 2 (NC, COM and NO ports)	Relay outputs
RS 485 A and B ports	RS 485 communication - For future use
2x AUX Ports	12V DC outputs to power 2x RFID readers
PWR + and -	12V DC input to power the Access Control device
2x Wiegand interface	Communication with 2x RFID Readers

Working with the RControl end-user mobile app

Download and install the M2M RControl mobile app for end users

Scan the QR codes below to download and install the RControl mobile app.

RControl app for Android:



RControl app for iOS:



Add App users

1. Open the RControl mobile app.
2. Click the Gear  button at the upper right corner and then click the **App Users** menu. Click the “+” button at the upper right corner of the screen and select one of the two options:
 - **Add new user** – Select this option if you would like to add a new non-existing user.
 - **Add existing user** – Select this option if you would like to add an already existing user.
3. In both cases, enter the login data required by the app.
4. To edit user settings, click on the user and you will be able to modify user settings.

Unlock the door via the app

① Before working with the app make sure your mobile phone is connected to the Internet.

1. Open your **RControl client app** and search for your M2M Access Control device by clicking the main menu button and then the **Search** button. You can search your device by its serial number provided with the device package.
2. Once you find your device, select it by clicking on it and it will appear on your RControl app main screen.
3. To unlock the Access Control, click on the **Open** button.

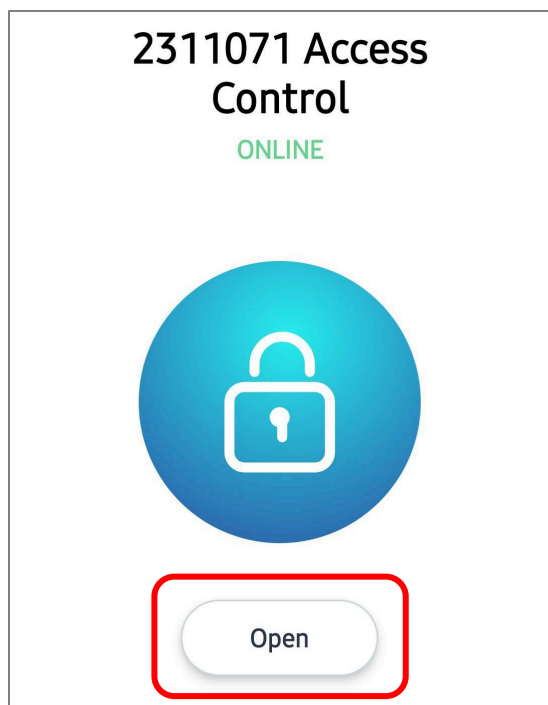

❶ You can also unlock the device via Bluetooth. This is explained below:

Enable Bluetooth for faster unlock

In the main view, just below the Unlock button, you may see a message prompting you to turn on Bluetooth on your mobile device if Bluetooth is disabled on your mobile device. Click this message to enable Bluetooth, or enable Bluetooth from your device settings.

❶ No pairing is required between the Access Control and your mobile device!

❶ To unlock via Bluetooth, hold your mobile phone close to the M2M Access Control device.

Events history

You can monitor events generated for one year in the past. You can view the events by switching to the **Events** tab, as shown in the picture below:

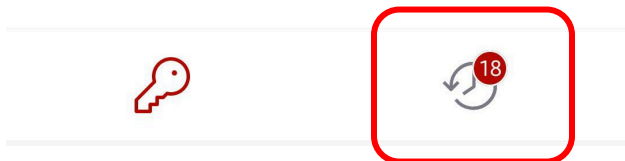

Enroll RFID Cards

To be able to unlock the system via RFID cards you will first need to add them to the M2M Access Control device. To do this, navigate to the **Settings** menu by clicking the Gear ⚙ button and then click the **Access Cards** menu. From the upper right edge of the screen tap on the “+” button and wait for the app to load into enrollment mode.

❶ Only master users are allowed to enroll RFID cards!

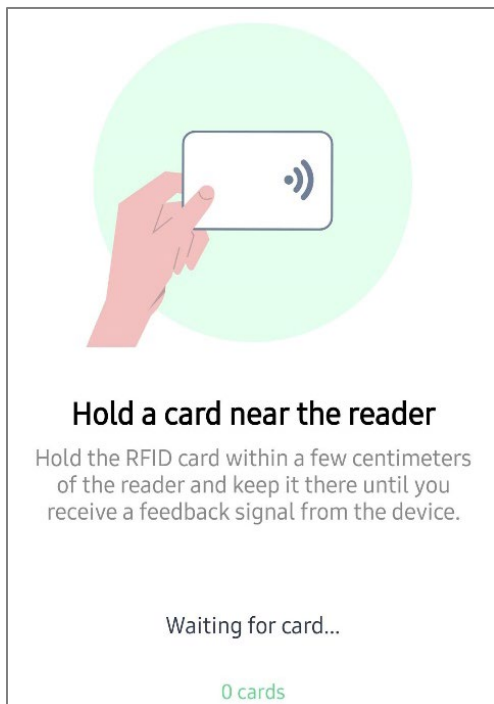

Follow the on-screen instructions to add one or more RFID cards to the Access Control. Only the RFID cards enrolled in the Access Control can unlock the system.

Unlock via an RFID card

Once you have enrolled RFID card(s), place the RFID card close to the RFID reader to unlock the system.

NFC Tags

Usage

NFC Tags can be used to unlock the system with the **RControl** app using the NFC functionality on your mobile device.

❶ Two NFC tags are included in the package and already pre-registered in the app. To use more tags, please contact M2M Services to purchase additional NFC tags.

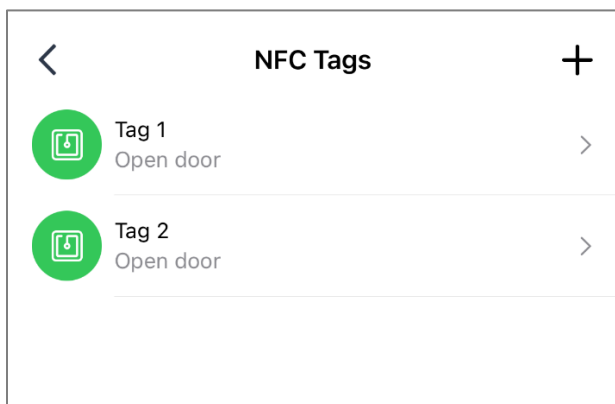

NFC Tags configuration

By default, the tags included in the package are pre-enrolled. To enroll additional NFC tags (purchased separately), follow the steps below:

1. Place the tags near the two RFID readers.
2. Enable NFC functionality on your mobile device.
3. Open your **RControl** app for Android or iOS, go to **Settings** ⚙️ -> **NFC Tags** -> Tap on the + **Add Tag** button and then place your phone near the desired NFC tag to enroll it.

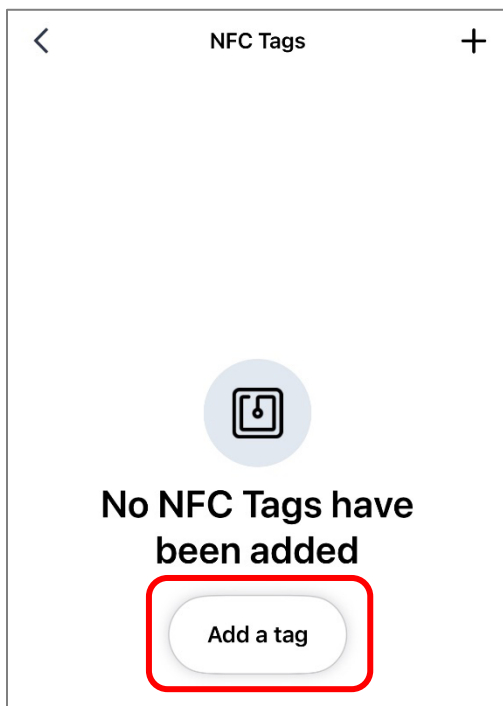

Once configured, hold your phone with NFC enabled close to the NFC tag to unlock the access control system.

Tap and hold on the tag or swipe the tag left to see options:

- Tap **Edit label** to edit label name shown in the app.
- Tap **Delete tag** to remove the tag from the app.